



precise products with global standard

Since a decade, Orion Coupling are engaged in offering our clients a large collection of Quick Release Coupling. These robust designed and sturdily constructed couplings are made through top grade material and precise technology in stands to meet global quality norms at our vendors' end. Further, Our products are also examined on various quality parameters of our vendor's highly established quality unit. Entire assortment is available in various customized sizes and dimensions to suit the variegated demands of our clients, which is specifically designed to meet need for simple, positive coupler. These are completely reliable and adaptable to a wide range of applications. Quick Release Coupling works on simple push & pull principle, wherein when the plug is pushed into the socket automatically locks in, resulting in a positive and leak proof connection. This action simultaneously ensures to open the valve and the fluid flow starts. Further, these are also very easy to disconnect and the valve shuts off automatically.



## **Orion Couplings**

**Manufacturers of Quick Release Couplings**

6 - C, S.No.28, Chaitanya Nagar, Dhankawadi, Pune 411043. (MS) India.

Website : [www.orioncouplings.com](http://www.orioncouplings.com) ■ Telefax : 020- 24365663

Email : [response@orioncouplings.com](mailto:response@orioncouplings.com)

# DOUBLE CHECK VALVE COUPLINGS

## HYDRAULIC COUPLINGS

## SERIES : DC-30

- These are used to connect Hydraulic / fluid lines.
- Both Socket and Plug consists of Non Return Valve.
- No leakages on disconnection
- Operating pressure is upto 3000 PSI.
- Can be used in Hydraulic Equipments , Presses to connect and Disconnect the lines immediately as per requirement.
- Available in Steel ( Zinc Passivation ) , SS-304 and Brass
- Threadings BSP (F)
- Standard sealing material - Nitrile ( -20 deg C to +75 deg C )
- Option - Viton ( -20 deg C to +170 deg C )
- Available sizes : 1/8" to 2"

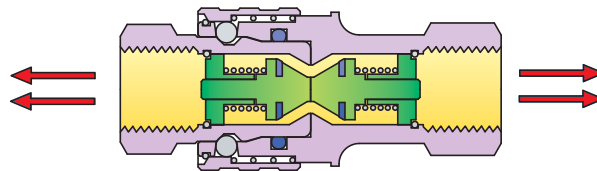

### Two Way Check Valve Couplings - Socket

Series/ Model	Size	Max Working Pressure PSI (Kgf/cm <sup>2</sup> )	L	ØD	Hex	A	T
DC - 30 1/8"S	1/8"	3000 (210)	48	25	f18 x A/F 14	10	1/8" BSP
DC - 30 1/4 " S	1/4"	3000 (210)	57.5	28	Hex A/F 22 x f 24	13	1/4" BSP
DC - 30 3/8 " S	3/8"	3000 (210)	56.5	35	f25 X A/F 22	14	3/8" BSP
DC - 30 1/2 " S	1/2"	3000 (210)	75	40	f33 x A/F 27	16	1/2" BSP
DC - 30 3/4 " S	3/4"	3000 (210)	78.5	45	f37 x A/F 32	18	3/4" BSP
DC - 30 1" S	1"	2500 (170)	85	51	f47 x A/F 41	21	1" BSP
DC - 30 1 1/2"S	1 1/2"	2000 (140)	101	63	f63 x A/F 55	24	1 1/2" BSP
DC - 30 2" S	2"	1500 (100)	99	76	f78 x A/F 70	27	2" BSP

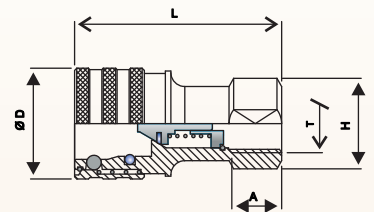

### Two Way Check Valve Couplings - Plug

Series/ Model	Size	Max Working Pressure PSI (Kgf/cm <sup>2</sup> )	L	ØD	Hex	A	T
DC - 30 1/8"P	1/8"	3000 (210)	30	19	Hex 14 x 16	10	1/8" BSP
DC - 30 1/4 "P	1/4"	3000 (210)	36	23	Hex 19 x 21	13	1/4" BSP
DC - 30 3/8 "P	3/8"	3000 (210)	40	25	Hex 22 x 24	14	3/8" BSP
DC - 30 1/2 "P	1/2"	3000 (210)	47	28	Hex 27 x 29	16	1/2" BSP
DC - 30 3/4 "P	3/4"	3000 (210)	51	28	Hex 32 x 36	18	3/4" BSP
DC - 30 1"P	1"	2500 (170)	55	32	f47 x A/F 41	21	1" BSP
DC - 30 1 1/2"P	1 1/2"	2000 (140)	102	33	f63 x A/F 55	24	1 1/2" BSP
DC - 30 2"P	2"	1500 (100)	100	38	f78 x A/F 70	27	2" BSP

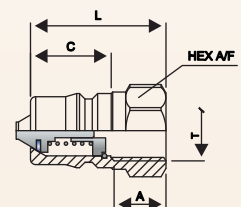

# SINGLE CHECK VALVE COUPLINGS

## PNEUMATIC COUPLINGS

## SERIES : SC-3 / SC-4

- These are used to connect Pneumatic lines such as portable pneumatic tools to compressed air line.
- The Socket consists of Non Return Valve and Plug having no Valve.
- Available in Various end combinations like Male Threads , Female Threads and Barbed ends.
- Available to connect PU Tubes.
- Operating pressure is upto 300 PSI.
- Can be used in water application with limited Pressure range.
- Available in Steel ( Nickel Plated ) , SS-304 and Brass
- Standard sealing material - Nitrile ( -20 deg C to +75 deg C )
- Option - Viton ( -20 deg C to +170 deg C )
- Available sizes : 1/8" to 1/2" SC-3 Series  
1/2" to 1" SC-4 Series

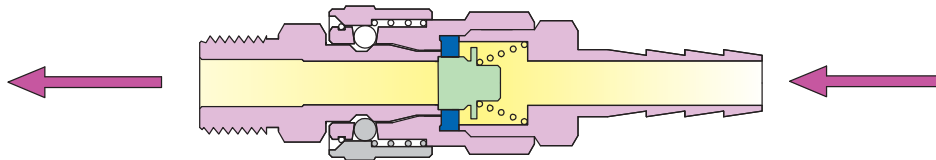

### Socket Male (SM)

Series	Model	Dimensions				
		L	ØD	Hex	A	T
SC-3	0108 SM	52.5	26	19	11	5/8" BSP
	0104 SM	52.5	26	19	11	1/4" BSP
	0308 SM	56.5	26	19	14	3/8" BSP
	A0102 SM	57.5	26	22	16	1/2" BSP
SC-4	B0102 SM	63.5	36	30	16	1/2" BSP
	0304 SM	65.5	36	30	17	3/4" BSP
	0100 SM	66.5	36	36	18	1" BSP

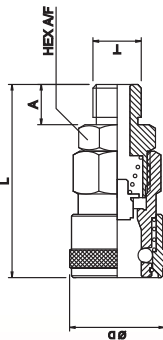

### Plug Male (PM)

Series	Model	Dimensions				
		L	C	Hex	A	Ø T
SC-3	0108 PM	39	20.2	14	11	1/8" BSP
	0104 PM	39	20.2	14	11	1/4" BSP
	0308 PM	42	20.2	19	14	3/8" BSP
	A0102 PM	44	20.2	22	16	1/2" BSP
SC-4	B0102 PM	48	23.2	22	16	1/2" BSP
	0304 PM	49	23.2	30	17	3/4" BSP
	0100 PM	50	23.2	36	18	1" BSP

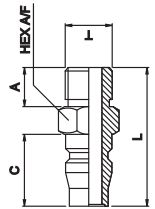

### Socket Female (SF)

Series	Model	Dimensions				
		L	ØD	Hex	A	T
SC-3	0108 SF	50.8	26	19	13	1/8" BSP
	0104 SF	50.8	26	19	13	1/4" BSP
	0308 SF	50.8	26	22	14	3/8" BSP
	A0102 SF	53.8	26	27	16	1/2" BSP
SC-4	B0102 SF	59	36	32	16	1/2" BSP
	0304 SF	61	36	32	18	3/4" BSP
	0100 SF	62	36	41	19	1" BSP

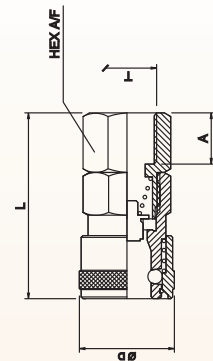

### Plug Female (PF)

Series	Model	Dimensions				
		L	C	Hex	A	Ø T
SC-3	0108 PF	36	20.2	17	13	1/8" BSP
	0104 PF	36	20.2	17	13	1/4" BSP
	0308 PF	37	20.2	22	14	3/8" BSP
	A0102 PF	39	20.2	27	16	1/2" BSP
SC-4	B0102 PF	42	23.2	27	16	1/2" BSP
	0304 PF	44	23.2	32	18	3/4" BSP
	0100 PF	45	23.2	41	19	1" BSP

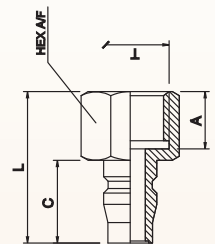

### Socket Hose (SH)

Series	Model	Dimensions				
		L	ØD	Hex	A	Ø T
SC-3	0108 SF	66.8	26	19	25	5.5
	0104 SF	66.8	26	19	25	9
	0308 SF	68.8	26	19	27	11.3
	A0102 SF	70.8	26	22	29	15
SC-4	B0102 SF	76.5	36	30	29	15
	0304 SF	82.5	36	30	35	21
	0100 SF	87.5	36	36	40	27

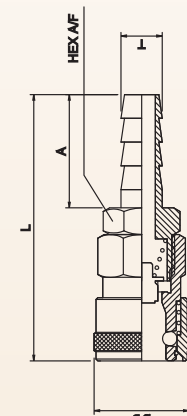

### Plug Hose (PH)

Series	Model	Dimensions				
		L	C	Ø H	A	Ø T
SC-3	0108 PH	50	20.2	16	25	5.5
	0104 PH	50	20.2	16	25	9
	0308 PH	52	20.2	16	27	11.3
	A0102 PH	54	20.2	19	29	15
SC-4	B0102 PH	59	23.2	22	29	15
	0304 PH	65	23.2	28	35	21
	0100 PH	70	23.2	32	40	27

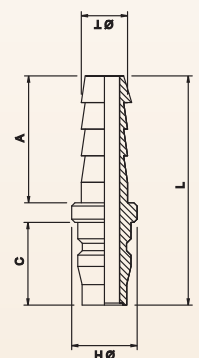

### Socket Socket For PU Tube

Series	Tube Size ID x OD	Model	Dimensions				
			L	ØD	Hex	A	ØT
SC-3	4 x 6	4 x 6 SPU	57.5	26	14	16	6
	6 x 10	6 x 10 SPU	57.5	26	14	16	10
	6.5 x 10	6.5 x 10 SPU	57.5	26	14	16	10
	8 x 12	8 x 12 SPU	61.5	26	19	20	12
	10 x 14	10 x 14 SPU	61.5	26	22	20	14
	12 x 16	12 x 16 SPU	61.5	26	24	20	16

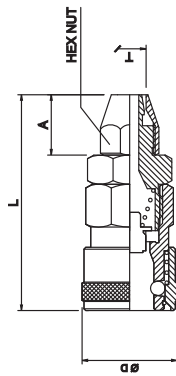

### Plug For PU Tube

Series	Tube Size ID x OD	Model	Dimensions				
			L	C	Hex	A	ØT
SC-3	4 x 6	4 x 6 PPU	44	20.2	14	16	6
	6 x 10	6 x 10 PPU	44	20.2	14	16	10
	6.5 x 10	6.5 x 10 PPU	44	20.2	14	16	10
	8 x 12	8 x 12 PPU	48	20.2	19	20	12
	10 x 14	10 x 14 PPU	48	20.2	22	20	14
	12 x 16	12 x 16 PPU	48	20.2	24	20	16

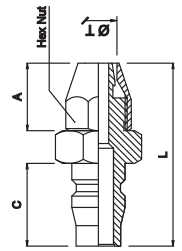

## MOULD COUPLINGS

### SERIES : MST

In plastic injection moulding process it is necessary to reduce the mould temperature. It ultimately increases the production cycle. Mould couplings are used for connecting coolant lines and injection mould.

- Gives These are designed without Valves in Socket and Plug.
- Gives Full flow of coolant with minimum losses.
- External Shut-off mechanism at supply end required to avoid fluid loss when disconnected.
- Available in end combinations of Male Threads and Barbed ends.
- Available in PU Tube connection at Socket end.
- Available in SS-304 and Brass
- Standard sealing material - Silicon
- Available sizes : 1/4" to 3/4"
- Specially designed seal in 3/4" size to avoid leakages due to misalignment caused by the heavy weight of the Hose Pipe

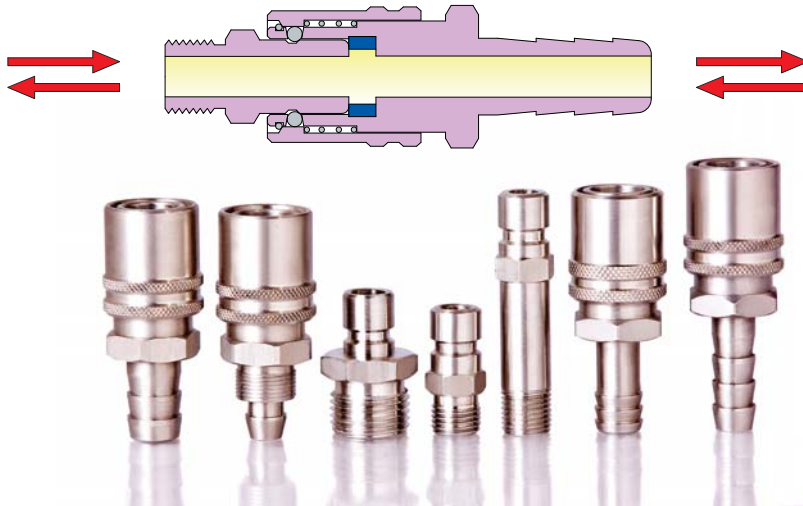

### Mould Coupler - Socket Hose (MSH)

Series	Model	L	Ø D	Hex A/F	A	Ø B
ST	0308 MSH	65.5	25	22	27	11.3
ST	0102 MSH	67.5	25	22	29	15

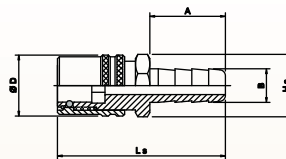

### Mould Coupler - Socket For PU Tube (MSPU)

Series	Tube Size ID x OD	Model	L	Ø D	Hex Nut	A	Ø T
ST	8 x 12	0812 MSPU	58.5	25	19	20	12
ST	10 x 14	1014 MSPU	58.5	25	22	20	14
ST	12 x 16	1216 MSPU	58.5	25	24	20	16

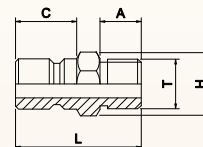

### Mould Plug - Plug Male (MPM)

Series	Model	L	C	Hex	A	T
ST	0104 MPM	33.5	16.3	14	11	1/4" BSP
ST	0308 MPM	36.5	16.3	19	14	3/8" BSP
ST	0102 MPM	38.5	16.3	22	16	1/2" BSP

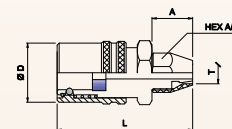

### Mould Plug - Long PlugMould

Series	Model	L	C	Hex	A	T	Extra Length
ST	0104 - 30 MPM	63.5	16.3	14	11	1/4" BSP	30
ST	0104 - 84 MPM	117.5	16.3	14	11	1/4" BSP	84.0
ST	0308 - 30 MPM	66.5	16.3	19	14	3/8" BSP	30
ST	0308 - 84 MPM	120.5	16.3	19	14	3/8" BSP	84

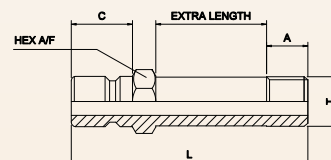

# STRAIGHT THROUGH COUPLINGS

## SERIES : ST

- These are designed without Valves in Socket and Plug.
- Gives Full flow with minimum losses.
- External Shut-off mechanism required to avoid fluid loss when disconnected.
- Available in Various end combinations like Male Threads , Female Threads and Barbed ends.
- Operating pressure is upto 1000 PSI.
- Can be used to transfer lequid , powder , slurry.
- Available in Steel ( Zinc Passivation ) , SS-304 and Brass
- Standard sealing material - Nitrile
- Option - Viton ( -20 deg C to +170 deg C )
- Available sizes : 1/4" to 2"

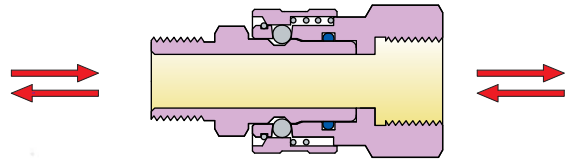

### Socket Male (SM)

Model	L	ØD	Hex	A	T
1TSM	30	17.5	6Hex. 14 x 16.2	9	1/8-28PT
2TSM	42	24	6Hex. 22 x 24.6	13	1/4-19PT
3TSM	46	28	6Hex. 37 x 30	14	3/8-19PT
4TSM	51	35	6Hex. 32 x 37	15	1/2-14PT
5TSM	61	36	6Hex. 32 x 34.2	18	3/4-14PT
6TSM	65	52	Ø51 x 2Hex x 47	19	1-11PT
7TSM	86	69	Ø62 x 2Hex x 54	23	1 1/4 11PT
8TSM	84	63	Ø63 x 2Hex x 55	24	1 1/2 - 11PT
9TSM	94	78	ØÆ x 2 Hex 70	27	2-11PT

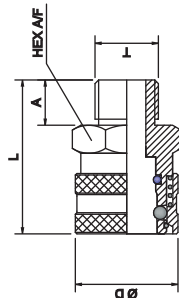

### Plug Male (PM)

Model	L	C	Hex	A	Ø T
1TPM	32	15.5	6Hex. 12 x 13.8	9	1/8-28PT
2TPM	36.5	16.5	6Hex. 14 x 16.2	13	1/4-19PT
3TPM	40	18	6Hex. 15 x 22	14	3/8-19PT
4TPM	49	25	6Hex. 22 x 24.2	16	1/2-14PT
5TPM	54	26	6Hex. 32 x 37	18	3/4-14PT
6TPM	53	22	Ø45 X 2Hex 41	19	1-11PT
7TPM	83	39	Ø59 x 2Hex x 54	23	1 1/4 11PT
8TPM	74	33	Ø63 x 2Hex x 55	24	1 1/2 - 11PT
9TPM	102	51	82Ø x 2 Hex 77	27	2-11PT

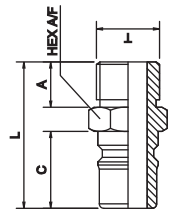

### Socket Female (SF)

Model	L	ØD	Hex	A	T
1TSM	25	17.5	6Hex. 14 x 16.2	9	1/8-28PT
2TSM	30.5	25	6Hex. 22 x 24.2	13	1/4-19PT
3TSM	40	28	6Hex. 27 x 30	14	3/8-19PT
4TSM	45	35	6Hex. 32 x 37	16	1/2-14PT
5TSM	48	36	6Hex. 32 x 34	19	3/4-14PT
6TSM	49	52	Ø51 x 47 A/F	21	1-11PT
7TSM	73	63	Ø63 x 55 A/F	24	1 1/4 11PT
8TSM	73	63	Ø63 x 55 A/F	24	1 1/2 - 11PT
9TSM	99	78	78Ø x 2 Hex 70	27	2-11PT

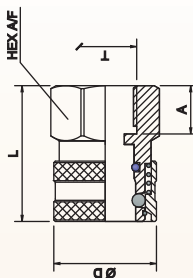

### Plug Female (PF)

Model	L	C	Hex	A	Ø T
1TPM	26	15.5	6Hex. 14 x 16.2	9	1/8-28PT
2TPM	33	16.5	6Hex. 17 x 19	13	1/4-19PT
3TPM	34	18	6Hex. 19 x 22	14	3/8-19PT
4TPM	45	25	6Hex. 32 x 37	16	1/2-14PT
5TPM	45	26	6Hex. 30 x 34	19	3/4-14PT
6TPM	47	22	Ø45 x 41 A/F	21	1-11PT
7TPM	62	33	Ø62 x 55 A/F	24	1 1/4 11PT
8TPM	62	33	Ø62 x 55 A/F	24	1 1/2 - 11PT
9TPM	100	38	78Ø x 2 Hex 70	27	2-11PT

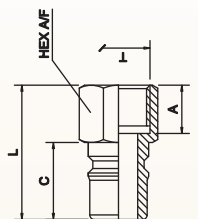

### Socket Hose (SH)

Model	L	ØD	Hex	A	Ø T
1TSH	40	17	6 Hex 17 x 19	20	6.5
2TSH	59	25	6 Hex 22 x 24	30	9
3TSH	70	28	6 Hex 27 x 30	30	11
4TSH	68	35	6 Hex 32 x 37	32	15
5TSH	78	36	6 Hex 32 x 37	35	21
6TSH	84	52	Ø49 x 45 A/F	40	27
12TSH	109	63	Ø63 x 55 A/F	49	41
16TSH	142	78	Ø78 x 70 A/F	73	54

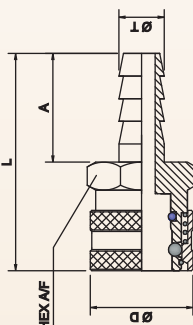

### Plug Hose (PH)

Model	L	C	Hex	A	Ø T
1TPH	41	15.5	Hex A/F 14	20	6.5
2TPH	53	16.5	Hex A/F 17	30	9
3TPH	53	18	Hex A/F 19	30	11
4TPH	64	25	Hex A/F 22	32	15
5TPH	71	26	Ø 30	35	21
6TPH	72	22	Ø 40	40	27
10TPH	121	39	Ø 48	70	34.5
12TPH	96	33	Ø 55	49	41
16TPH	123	38	Ø 68	73	54

